



FlexScan[®]
Business Monitor Solutions



Now, find your workstyle.

Both performance and environmental consciousness are important in today's society.

FlexScan combines cutting-edge technology with sustainable design to achieve the ideal in workstyle innovation.

Whether it be in the office or at home, FlexScan enables business professionals to achieve comfort and efficiency while staying kind to the environment.

Now, find your workstyle.



FlexScan®



Open-Plan Office



Satellite Office





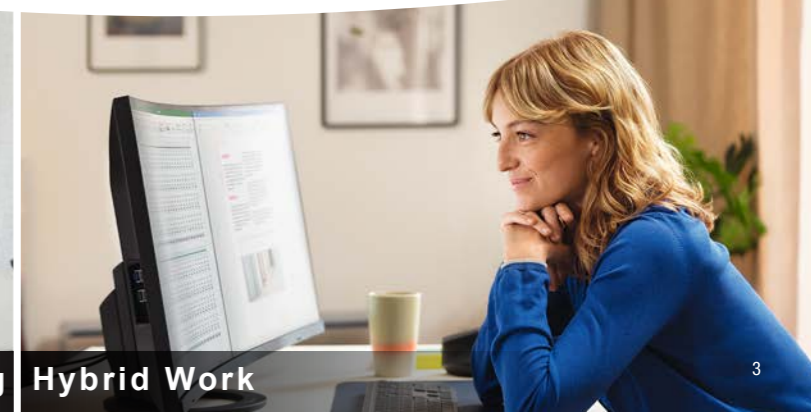











Telecommuting



Hybrid Work

Find the Solution that Suits Your Workstyle Needs.

	Premium Plus							Premium							New Standard			Basic			
	I need to use webcam and mic <i>See page 9</i>																				
	My tasks require a large working area <i>See page 7 - 9</i>							I need to use multiple monitors with less cable clutter <i>See page 11</i>													
	I need a stable network connection for web meetings <i>See page 11</i>																				
	Having my battery always fully charged allows me to focus on work <i>See page 10</i>																	I'm using a desktop PC and need a good monitor			
	I prefer to work with an external mouse and keyboard when using my laptop <i>See page 10</i>																				
	Eye care and ergonomics are important to me <i>See pages 12 - 13</i>																				
	 EV4340X  EV3895  NEW EV3450XC  EV3240X  EV2740X  EV2795  EV2495							 EV2490  EV2781  EV2485  EV2480							 EV2760  EV2456  EV2460  EV2360						
Inputs	USB Type-C®	✓	✓	✓	✓	✓	✓	✓	✓	✓	✓	✓									
	Webcam & Mic			✓																	
	Daisy Chain						✓	✓	✓												
	Network Connection	✓	✓	✓	✓	✓	✓	✓	✓												
	Power Delivery	✓	✓	✓	✓	✓	✓	✓	✓	✓	✓	✓									
	Connect Peripherals	✓	✓	✓	✓	✓	✓	✓	✓	✓	✓	✓									
	DisplayPort™	✓	✓	✓	✓	✓	✓	✓	✓	✓	✓	✓	✓	✓	✓	✓					
	HDMI®	✓	✓	✓	✓	✓	✓	✓	✓	✓	✓	✓	✓	✓	✓	✓					
	DVI-D												✓	✓	✓						
D-Sub mini 15 pin													✓	✓	✓						
Eye Care Functions	✓	✓	✓	✓	✓	✓	✓	✓	✓	✓	✓	✓	✓	✓	✓						
USB Ports	3	4	3	4	4	4	4	4	4	4	4	4	2	4	2						
Panel Size	42.5"	37.5" Curved	34.1" Curved	31.5"	27"	27"	24.1"	23.8"	27"	24.1"	23.8"	27"	24.1"	23.8"	22.5"						
Native Resolution	4K 3840×2160	UWQHD+ 3840×1600	UWQHD 3440×1440	4K 3840×2160	4K 3840×2160	WQHD 2560×1440	WUXGA 1920×1200	Full HD 1920×1080	WQHD 2560×1440	WUXGA 1920×1200	Full HD 1920×1080	WQHD 2560×1440	WUXGA 1920×1200	Full HD 1920×1080	WUXGA 1920×1200						

See pages 22 - 25 for a detailed list and specifications of the complete FlexScan lineup, including square and wide monitors.

Bask in Beauty.



NEW FlexScan EV4340X



Aesthetically Pleasing Design

The minimalist design of FlexScan monitors allows them to fit naturally in your work environment. Even with the black borders along the perimeter of the LCD there is very little distance between the display area of each screen in a multi-monitor configuration which makes for almost seamless viewing.

Color Coordination

The monitor is available in white, for a brighter office environment, or black, for a sleek and stylish mood. The cables and stand also come in matching colors for a fully coordinated look.



Tackle More with 4K

The EV4340X / EV3240X / EV2740X support 4K (3840 x 2160 pixel) resolution, displaying four times the amount of information than standard Full HD (1920 x 1080 pixel) monitors. You can view more applications simultaneously on a single screen, greatly reducing the need to scroll or switch windows frequently.



Better Meeting Experience

The EV4340X displays at 4K resolution across a spacious 42.5-inch screen. The built-in 4-watt speakers provide clear audio for meeting spaces with several people. The included remote control can be used change settings when the monitor is out of reach, such as in wall-mounted installations.



Connect. Communicate. Collaborate.



NEW FlexScan® EV3450XC

See Everything at a Comfortable Distance

The curved screen of the EV3895 / EV3450XC gently brings the edges of the monitor in to a comfortable distance, improving visibility, focus, and immersion.

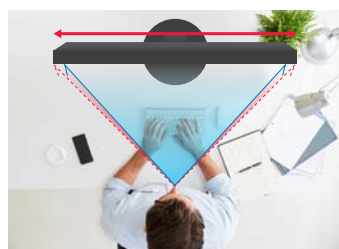

More Space, Seamless Viewing

The ultrawide screen of the EV3895 / EV3450XC provides an expanded workspace for flexible arrangement of multiple applications without the obtrusive bezels characteristic of multi-monitor setups.

Full HD (1920 x 1080)	
EV3450XC UWQHD (3440 x 1440)	x2.4
EV3895 UWQHD+ (3840 x 1600)	x3

Built-In Webcam / Mic / Speaker

The EV3450XC's webcam, microphone, and speaker are discreetly integrated into the bezel to blend in with your workspace. High quality video and audio make it easy to communicate with colleagues.

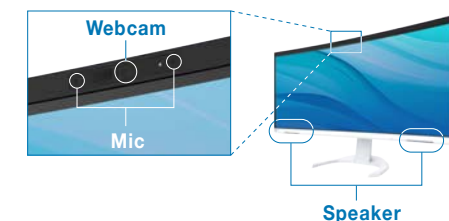

Get Connected. Get Started.



Streamlined Connection with USB Type-C

USB Type-C compatible monitors make it faster and easier to connect a laptop when moving between workstations, or when working away from the office.

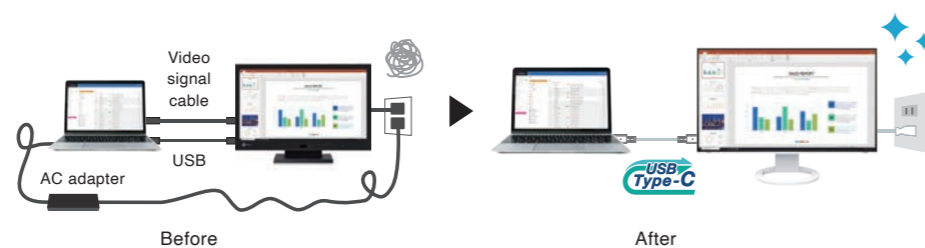

Power Delivery

Power delivery via USB Type-C reliably charges laptops and small desktop PCs. This eliminates the need for a laptop's bulky power supply unit, freeing up desk space.



Directly Connect Peripherals

Laptops often have limited connectivity options for peripherals. Connecting to a USB Type-C compatible monitor gives access to a hub with multiple USB Type-A ports for easily connecting an external keyboard, mouse, web camera, or storage device.



Compatible Models EV4340X / EV3895 / EV3450XC / EV3240X / EV2740X / EV2795 / EV2495 / EV2490 / EV2781 / EV2485 / EV2480

[? Visit Our Website](#) |
 [Infographic: "What is USB Type-C?"](#)

Stable Network Connection

While many modern laptops are not equipped with a dedicated LAN port, a USB Type-C compatible monitor with a built-in LAN adapter provides users with access to the network via the monitor. This allows users to conduct conference calls or data transfers reliably and at high speed.



Compatible Models EV4340X / EV3895 / EV3450XC / EV3240X / EV2740X / EV2795 / EV2495 / EV2490

Protecting Network Security in Shared Workspaces

Social change has led to a diversification of workspace models and workstyles. More companies are adopting shared office spaces, conference rooms, and meeting spaces. EIZO MAC Address Clone Utility software is available to enable the convenient use of wired LAN functions in a secure environment through MAC address authentication when using EIZO LAN port monitors in such spaces. *Supports Windows OS only.*



Daisy Chain

With a daisy chain users can connect multiple monitors via a single video signal output. Connecting monitors in a daisy chain simplifies cable management, tidying up the back of the desk for an even cleaner office aesthetic.



Compatible Models EV2795 / EV2495 / EV2490

[? Visit Our Website](#) |
 [What do I need to know about daisy chaining?](#)

Say Goodbye to Tired Eyes.



Glare Reduction

Anti-Glare Coating

FlexScan monitors are treated with an anti-glare coating to reduce screen reflections caused by ambient lighting. The coating scatters incoming light, reducing the amount of light reflected into your eyes.

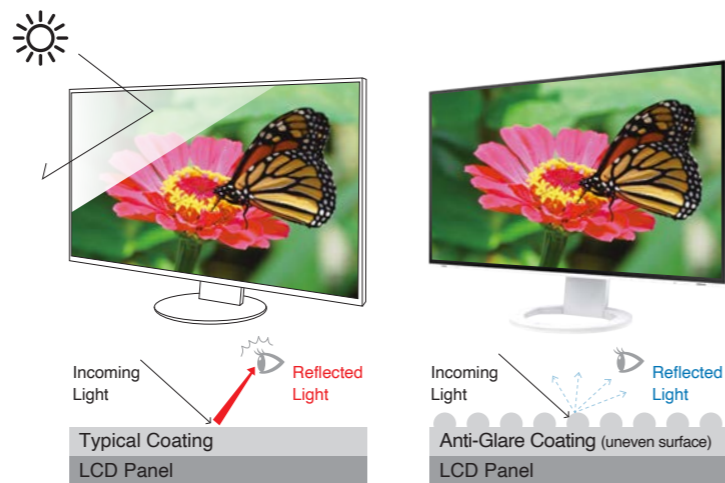

Flicker-Free Viewing

EyeCare Dimming Mode

In low brightness ranges, users may perceive flicker on a typical LED backlight, causing eye fatigue and often headaches. EyeCare is a dimming function that cuts flicker to a degree that human eyes cannot detect, reducing eye fatigue and flicker-related headaches, without affecting color stability of the monitor.



FlexScan monitors are certified by TÜV Rheinland to have low blue light and be flicker-free.

Auto Brightness Control

Always the Ideal Brightness

The Auto EcoView function automatically adjusts the brightness of your monitor according to ambient lighting. This ensures your monitor is always at the optimal brightness for reducing eye fatigue.



Blue Light Reduction

Paper Mode

Do you find that your screen is often too bright to read text comfortably? FlexScan monitors are equipped with Paper Mode which reduces blue light to simulate paper, making it less straining on your eyes. When used in conjunction with the Auto EcoView function, blue light is even further reduced.

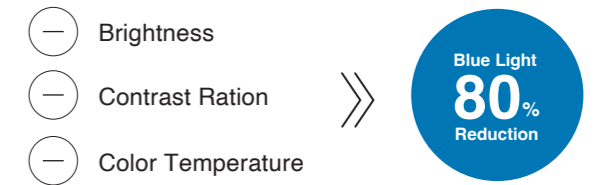

Stable Image Even at Low Brightness

Reduce Brightness to Approximately 1 cd/m²

Frameless and wide monitors can be adjusted to a brightness of approximately 1 cd/m² without negatively impacting the color or stability of the screen.

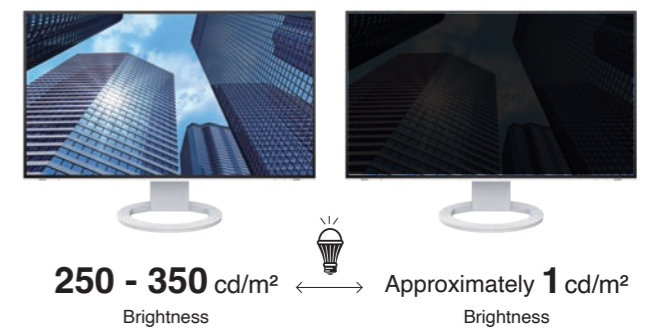

[Visit Our Website](#) | "The Latest on Computer Screens and Eye Fatigue"

[Visit Our Website](#) | "Designed to Protect Your Eyes"

The Perfect Position.



Space-Saving Positioning

For the most limited workspaces, a laptop can fit comfortably under the monitor with the stand at maximum height. This allows you to use the laptop as a second screen without taking up valuable desktop space.

The specific movement ranges of stands varies by model. See pages 22 - 25 for specifications of all monitors.

Portrait Mode

View web pages and documents easily by switching the monitor to portrait mode simply by rotating the screen.

The specific movement ranges of stands varies by model. See pages 22 - 25 for specifications of all monitors.

■ EV2480

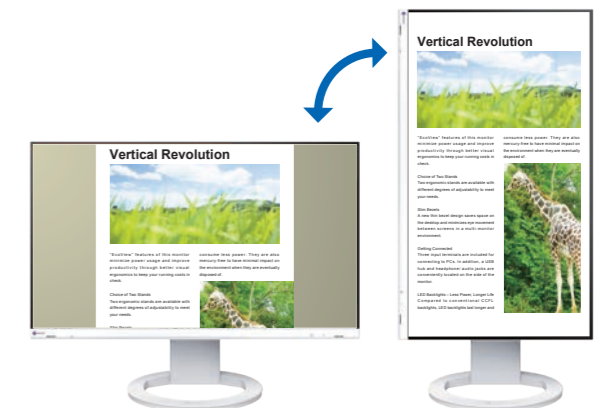
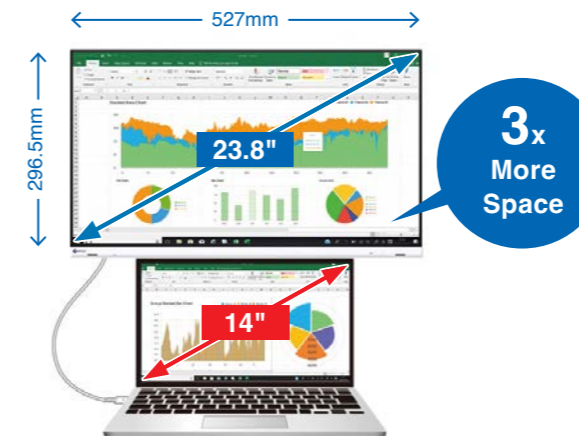

Versatile Stand

The stands feature height adjustment, tilt, and swivel, while saving space and remaining stylish. Quickly and smoothly adjust your monitor to the perfect position.

The specific movement ranges of stands varies by model. See pages 22 - 25 for specifications of all monitors.

■ EV2795 / EV2781

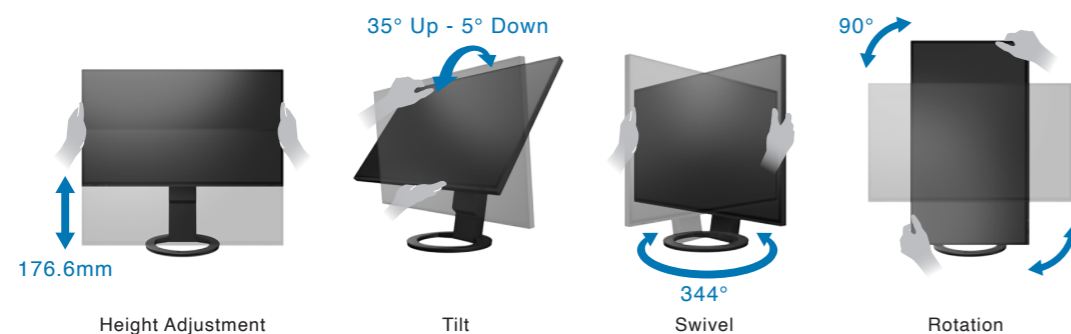

Wide Height Adjustment Range

The ergonomic stand allows you to adjust the monitor to the most comfortable position suited for the workplace or home office.

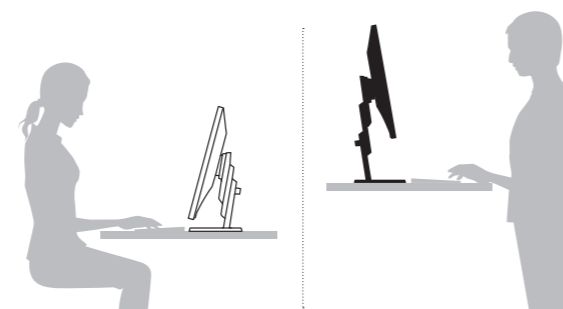

Free Up Your Workspace

VESA-compliant stand brackets let you easily mount a client terminal such as a thin client or mini PC to the back of the monitor. The space the client terminal previously occupied is now freed up so you can make better use of your desktop. Even with the client terminal attached you can adjust the monitor's stand freely.

Please check EIZO website for supported models.

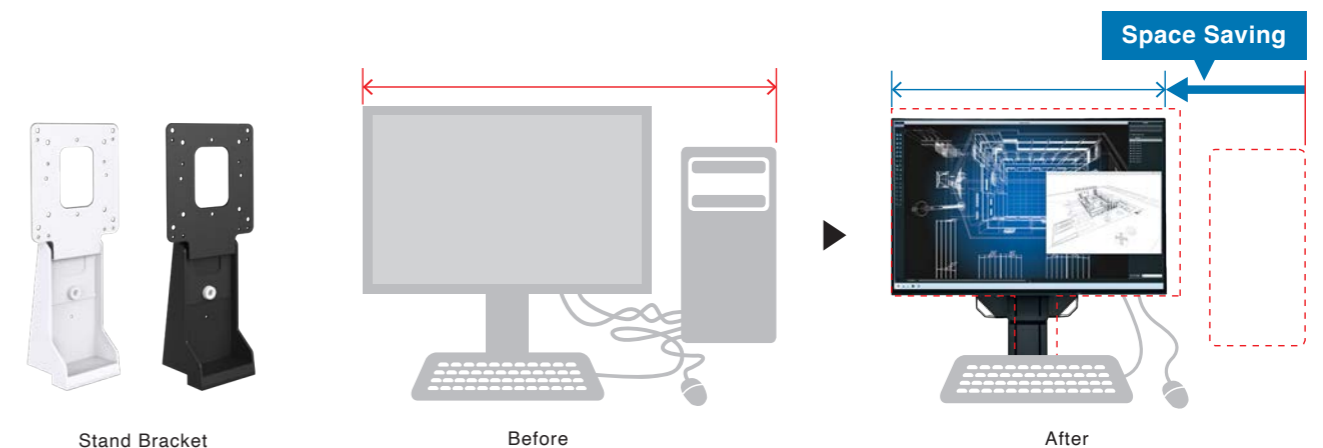

Intelligent Software to Work Better.

SCREEN INSTYLE

EIZO's free Screen InStyle software automatically optimizes your monitor to make your user environment more comfortable.

Both Windows and macOS versions are available.

See pages 22 - 25 for compatible monitors.

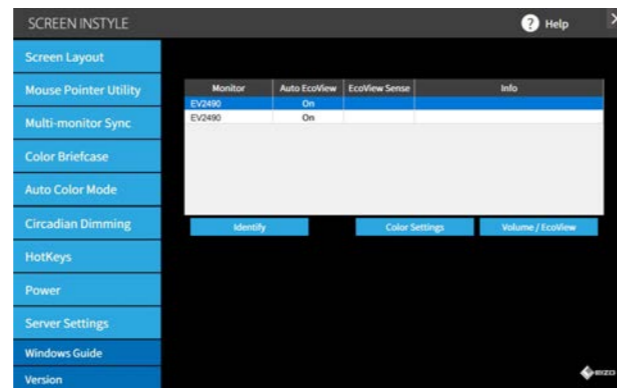

Automatically Change the Color Mode for Each Application

Auto Color Mode

FlexScan monitors have multiple color modes designed for different uses. Use the Auto Color Mode to assign a color mode to turn on when using specific applications such as those for writing documents, photo viewing, creating illustrations or watching movies. When an application is opened the screen will automatically switch to the assigned color mode, making manual switching unnecessary.



Organize Your Desktop to Increase Work Efficiency

Screen Layout

This function allows you to divide the desktop and arrange each program's window neatly across the screen to help you work smart and efficiently.



Easily Switch Between Inputs / Color Modes

Assign Hotkeys for Switching Input Signals and Color Modes

You can assign keyboard hotkeys to switch between color modes or input signals of two PCs connected to your monitor.

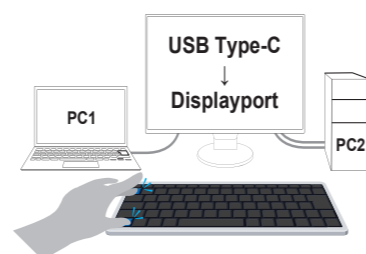

Multi-Monitor Convenience

Synchronize Screen Adjustments

When using multiple monitors, save time by synchronizing all the monitors with each other. If you change the color mode, brightness or color temperature of one monitor, the rest will automatically change to the same.

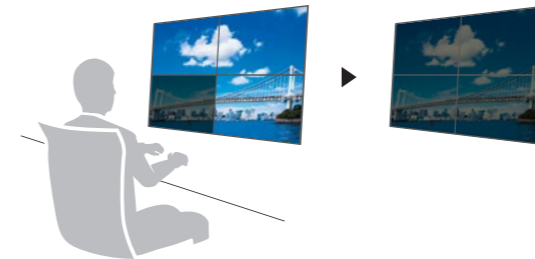

On/Off All at Once

When one monitor's power is turned off, all other monitors will also turn off. Save energy by easily turning off all monitors at once.

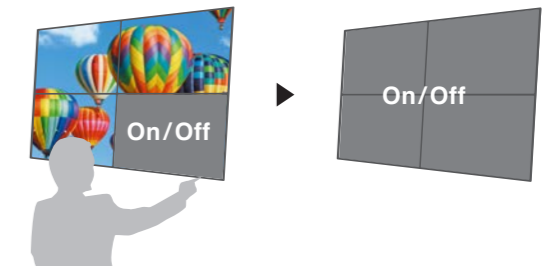

Screen InStyle Server

Effectively Monitor Asset Management

Automatically Receive Monitor or PC Information

With Screen InStyle Server receive information such as the model name and serial number of any monitor connected to your network. Additionally, see information from the computer that each monitor is connected to, such as the OS, IP address and computer name.

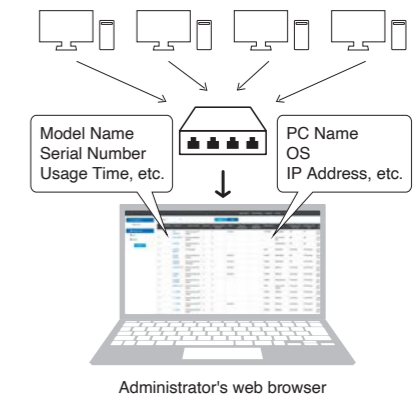

Control Settings on Multiple Monitors at Once

Manage Multiple Monitors from One Location

Control multiple monitors' settings such as color mode, brightness, and eco functions from a remote location. Furthermore, prevent unintended setting changes by locking the operation switch.

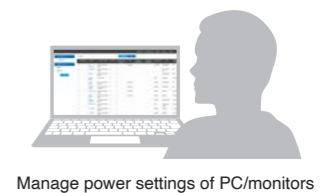

Conserve Power with Central Management

Manage various power settings of networked PCs and monitors. Set the monitor to turn off or the PC to sleep after a set period of inactivity.

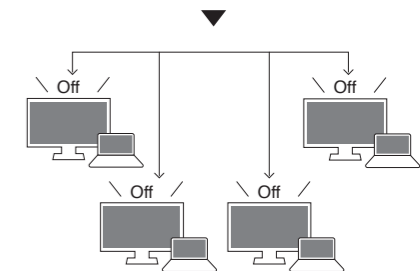

Improve Security with Automatic Locking

Improve office security by setting networked PCs to automatically lock after a certain period of inactivity. This ensures the PC remains secure after the user leaves their desk.

Download Screen InStyle and Screen InStyle Server >>>



Care for the Environment



Sustainable Monitor Design

Achieving a sustainable society where we do no harm to the environment nor waste precious resources is an important initiative for businesses and communities. FlexScan Sustainable Monitors are at the forefront of EIZO's efforts to contribute to this sustainable future.

Learn more about EIZO Sustainable Monitors



Conserve to Preserve

FlexScan Sustainable Monitors include models which are made of more than 80% recycled plastic. This cuts down on the amount of plastic waste going into the environment, conserves resources, and promotes reuse of materials for preserving our natural ecosystems.



Effortlessly Save on Power Consumption

FlexScan Sustainable Monitors' Auto EcoView function automatically adjusts the screen's brightness according to changes in the ambient lighting. The EcoView Optimizer 2 function fine-tunes the balance between brightness and gain according to the content displayed on the screen. These proprietary EcoView technologies cut power consumption by as much as 50%* compared to displaying at maximum brightness.

*Typical power consumption when not using USB power delivery



Visit Our Website

"How Green is Your Monitor?" Eco Calculator



Cushioning Environmental Impact

Starting with the most recent models, FlexScan Sustainable Monitors are moving away from using plastic and styrofoam in the packaging to reduce environmental impact. The monitors are safely packed using molded pulp, which is made from recycled cardboard and newspaper, and cables are wrapped in paper instead of plastic bags.



Collective Environmental Consciousness

EIZO offers corporate customers an option for collective packaging, where multiple monitors can be packed together in a single box. We can also leave out any unneeded stands or cables. This reduces the amount of packaging materials used, improves loading efficiency, and significantly reduces unpacking and installation time, leading to less overall waste.



Certified Sustainable

EIZO complies with international laws and regulations regarding environmental protection and effective use of energy. In addition, FlexScan Sustainable Monitors meet the latest environmental standards, such as ENERGY STAR®, EPEAT, and TCO Certified Generation 9.



Our Contribution to SDGs

As part of its corporate social responsibility (CSR) activities, EIZO is contributing towards the United Nations' Sustainable Development Goals (SDGs).

SUSTAINABLE DEVELOPMENT GOALS



Innovative Solutions

Built-In Color Calibration Sensors



Automatically calibrates while you work

IP Decoding Solutions



PC-less connection

Switch

Visibility Enhancement Technology



Ultra-High Sensitivity HD Cameras



Image Optimization System

Market-Focused Cloud Solutions



Air Traffic Control

Creative Work

Healthcare

Visual Technology Company



50+ Years of Expertise

Extensive Market Reach



FlexScan

Business Enterprise



ColorEdge

Creative Work

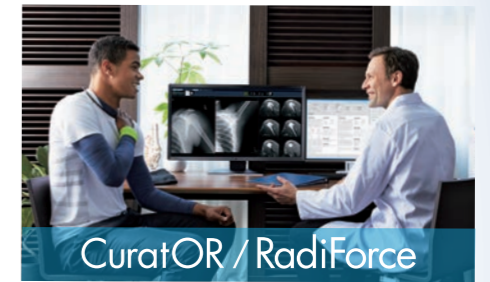

CuratOR / RadiForce

Healthcare



Research and Development



Global Reach



Manufacturing

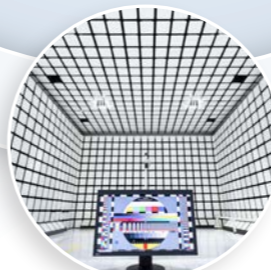

Quality Control



Customization



DuraVision

Security & Surveillance / Maritime



Raptor / Re/Vue / SafeGuard

Air Traffic Control

Software for Improved Workflow



Use a single mouse across two PCs

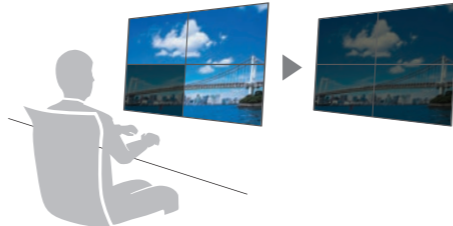

Synchronized adjustment of multiple monitors



Simplified CMS with automatic software and printer settings adjustment

EIZO Corporation

153 Shimokashiwano, Hakusan, Ishikawa 924-8566 Japan
Phone +81-76-277-6794

<https://www.eizoglobal.com>

EIZO, the EIZO logo, FlexScan, ColorEdge, Curator, RadiForce, DuraVision, and Raptor are registered trademarks of EIZO Corporation in Japan and other countries. ReVue, SafeGuard and Screen InStyle are trademarks of EIZO Corporation. The terms HDMI, HDMI High-Definition Multimedia Interface, HDMI trade dress and the HDMI Logos are trademarks or registered trademarks of HDMI Licensing Administrator, Inc. DisplayPort and VESA are trademarks of the Video Electronics Standards Association in the United States and other countries. Windows, Microsoft are registered trademarks of Microsoft Corporation in the United States and other countries. DICOM is the registered trademark of the National Electrical Manufacturers Association for its standards publications relating to digital communications of medical information. USB Type-C is a registered trademark of USB Implementers Forum, Inc. macOS and macOS Sierra are registered trademarks of Apple Inc. ENERGY STAR is a registered trademark of the United States Environmental Protection Agency in the United States and other countries. All other company names, product names, and logos are trademarks or registered trademarks of their respective owners. Some screen images are used with permission from Microsoft. Specifications are subject to change without notice.

Copyright © 2024 EIZO Corporation. All rights reserved. (240602)

